

Elyria 329-5586  
Lorain 244-6261  
ext. 5586

LORAIN COUNTY ENGINEER  
247 Hadaway Street  
Elyria, Ohio 44035

Oberlin 775-1351  
Wellington 647-2351

DITCH ENCLOSURE PERMIT APPLICATION

Section 5543.16 of the Ohio Revised Code: Construction and Repair of Approaches and Driveways Cost. The owners of land shall construct and keep in repair all approaches or driveways from the public roads, under the direction of the County Engineer.

OWNERS NAME \_\_\_\_\_

ADDRESS \_\_\_\_\_

CITY/ZIP \_\_\_\_\_ TELEPHONE \_\_\_\_\_

Proposed Ditch enclosure to be located and constructed within the Right-of-Way of \_\_\_\_\_

Road in \_\_\_\_\_ Township along N \_ S \_ E \_ W \_ side of the road \_\_\_\_\_ miles (feet)

N \_ S \_ E \_ W \_ of the \_\_\_\_\_ intersection.

Length of proposed ditch enclosure: \_\_\_\_\_

Said owner \_\_\_\_\_ shall at all times protect and save harmless Lorain County from any and all claims arising in any manner from the construction and maintenance of said ditch enclosure. Owner shall be responsible for locating and marking all pipe and tiles entering roadside ditch with wooden stakes.

SIGNATURE \_\_\_\_\_ DATE \_\_\_\_\_

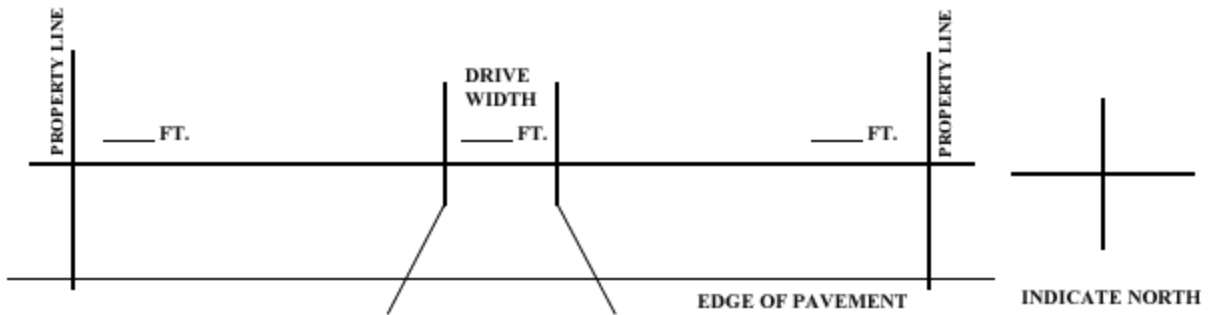

Show in sketch where proposed ditch enclosure will be located in relation to property lines, right-of-way and driveway. Show all inlets, firings, etc.

LIST OF MATERIAL

---



---



---

Fill out all but the list of material

- Following the purchase of pipe by owner, please contact the Lorain County Garage at 326-5880 when the pipe is delivered to schedule the installation of the pipe. The County will furnish pipe cover as available. Final grading, top soil, mulch, and seeding to be done by property owner.
- Minimum diameter of pipe: 12 inch (may be larger)
- The pipe is to be purchased by owner only upon receipt of signed permit from the Lorain County Engineer's Office.